

Assembly

Insert SD card as below:

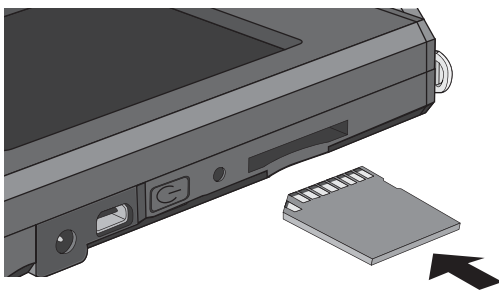

Installing cover strap:

- step1. Unscrew the strap
- step2. Tie strap to the holder
- step3. Tie strap to the sensor cover
- step4. Screw the strap

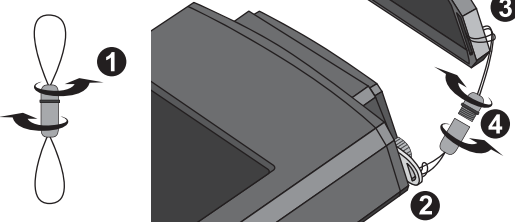

Accessory - 1

Li-ion battery installation:

- step1. Remove battery cover
- step2. Install Li-ion battery as below
- step3. Put battery cover back

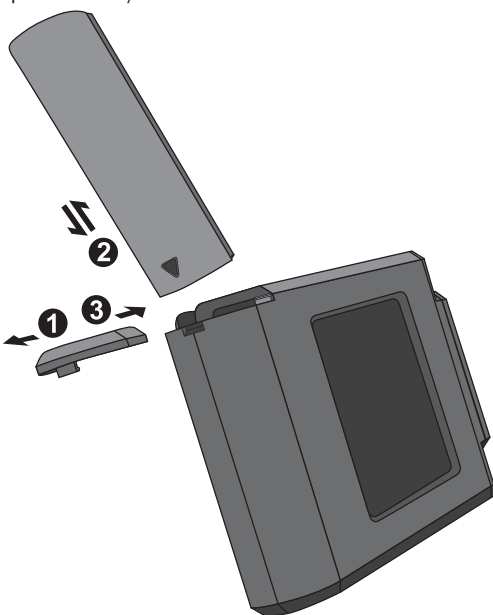

Physical Description

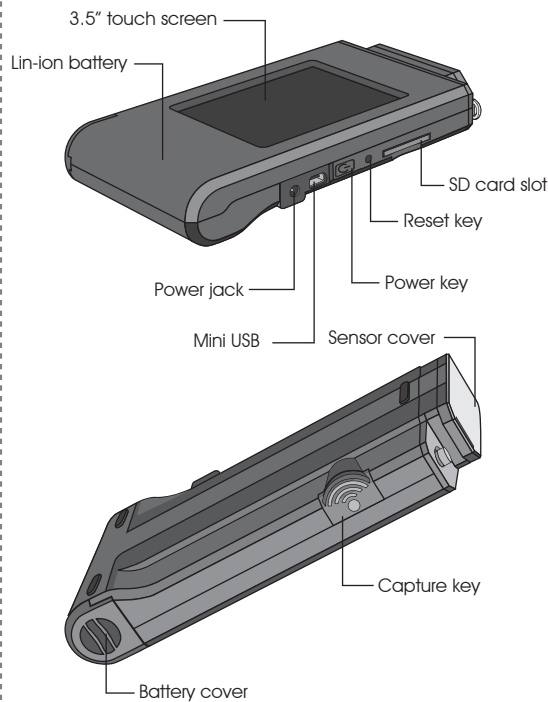

Accessory - 2

Charging the SPECTRUM MK350:

Please plug AC adaptor into power jack

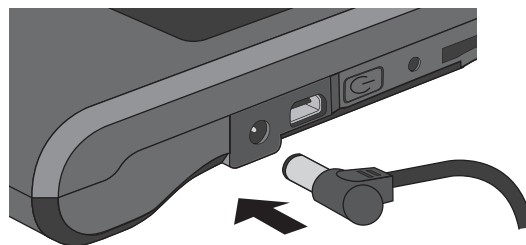

Transferring data:

Connect mini USB to your PC
note: MK350 saves raw data only

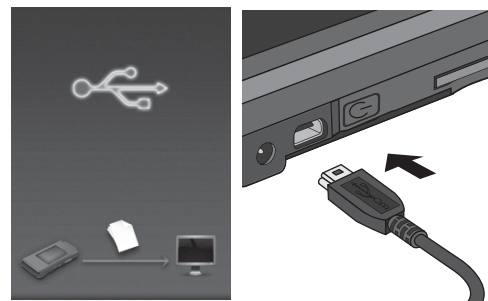

WWW.MK350.COM



SPECTROMETER MK350 USER MANUAL

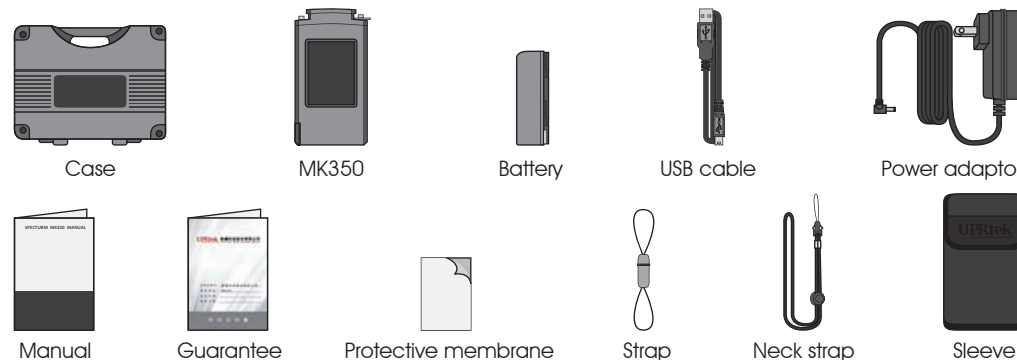

SPECIFICATIONS

Spectral Bandwidth/Resolution	12 nm
Wavelength Range	360 ~ 750 nm
Digital Resolution	16 bits
Wavelength Data Increment	1 nm
Color Accuracy	xy: ±0.002
Color Repeatability	xy: ±0.0005
Operating Temperature Range	0 ~ 35°C
Storage Temperature Range	-10 ~ 45°C
Date Output Interface	SD, USB 2.0 (Support mass storage only)
Display	3.5" LCD 320X240 Touch Panel
Battery	2500mAh / Rechargeable Li-ion Battery
Dimension	144.2 x 78.0 x 24.0 mm
Weight (Including battery)	250g ± 20g
Measurement Capabilities	1. Spectral Irradiance 2. C.I.E Chromaticity Coordinates (1) C.I.E 1931 x,y Coordinates (2) C.I.E 1976 U.C.S u',v' Coordinates 3. Peak Wavelength 4. Correlated Color Temperature; CCT (in Kelvins) 5. Color Rendering Index; Ra (Rendering Average) 6. Illuminance / Lux
Illuminance Meter Function	Conditional support measure illumiance under 30° from 70 to 70,000LUX

Home Index Icons

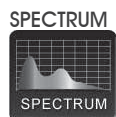

System Setting



Measurement Modes

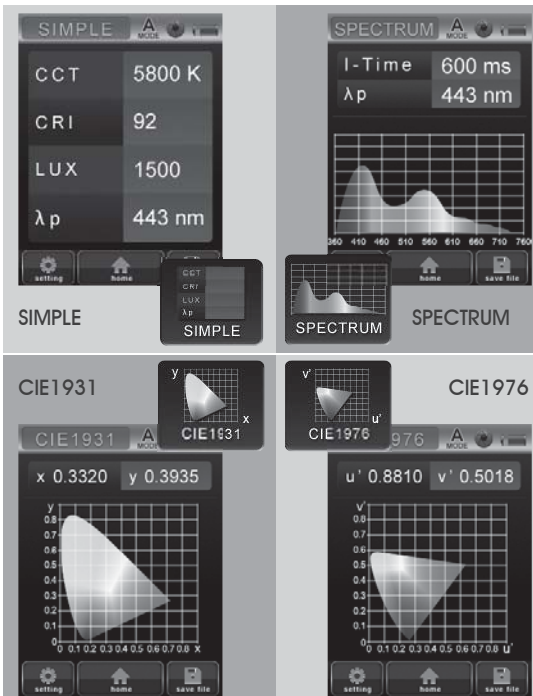

Interface

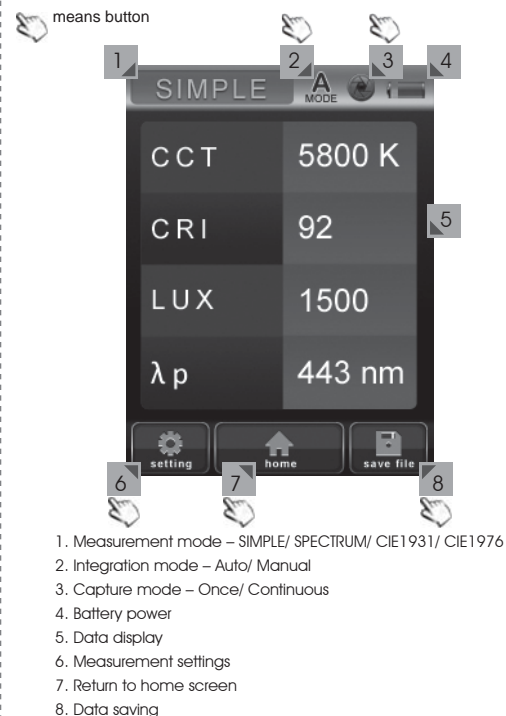

Measurement

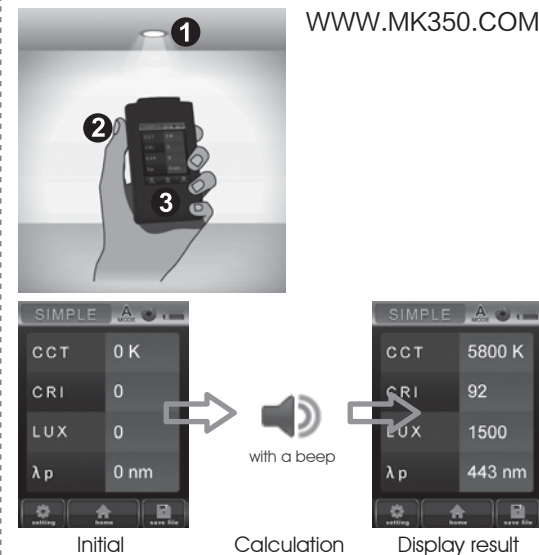

- Step 1 : Point sensor head towards light source
 Step 2 : Push the button
 Step 3 : Read data measurement on screen

System Settings - 1



Main menu settings

1. Settings
2. Next page
3. Return
4. Previous page

Submenu settings

5. Setting item
6. Setting content
7. Confirm
8. Deny

System Settings - 2

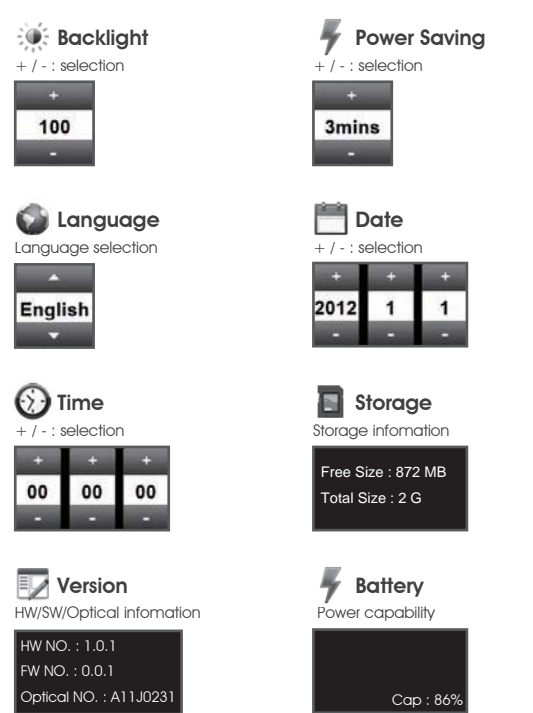

Measurement Settings - 1

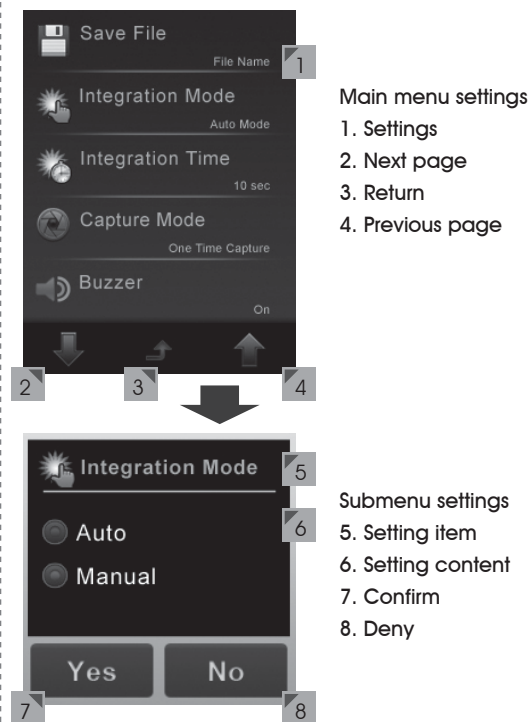

Main menu settings

1. Settings
2. Next page
3. Return
4. Previous page

Submenu settings

5. Setting item
6. Setting content
7. Confirm
8. Deny

Measurement Settings - 2

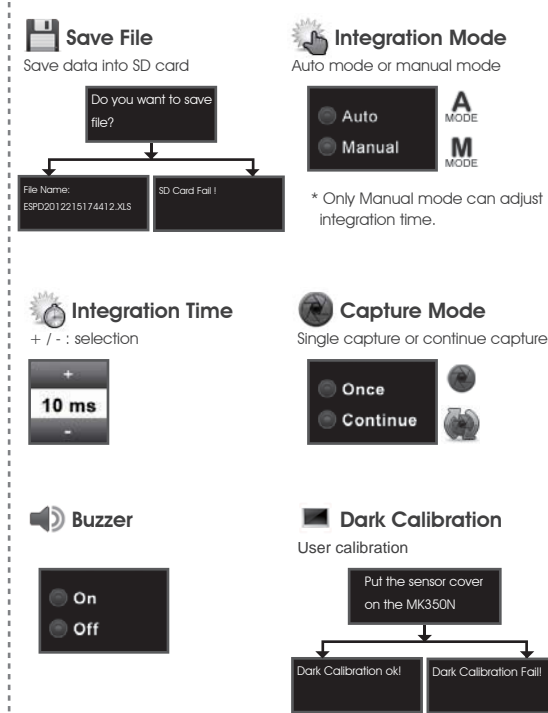

Integration Mode

Auto mode or manual mode

* Only Manual mode can adjust integration time.

Capture Mode

Single capture or continue capture

Dark Calibration

User calibration

Put the sensor cover on the MK350N

Dark Calibration ok! Dark Calibration Fail!